

QUICK START GUIDE

MODEL: KS-2619

01 / Installation Instructions

Press the release buckle, connect the main handle to the extendable handle until you hear a CLICK.



NOTE: Please fully charge the scrubber before first use.

Brush head assemble and disassemble

- Hold the scrubber with one hand and then snap the selected head brush when it is secured.
- The brush head can be removed by pulling out only in vertical direction.



NOTE

For safety transportation, the battery of the product is at low power when it's dispatched. Please charge it fully before the first usage. It is better to hang the scrubber up in a place without direct sun exposure or humid air to protect the battery.

The actual working time depends on the cleanliness of the area. For cleaning stubborn stains, if you press the brush to clean, the use time will be shortened.

02 / Suggestion for Brush Usages



Dome Brush

Great for cleaning bathtub, sink, etc.

Large Flat Brush

Perfect for cleaning floor, glass, bathroom door, mirror, etc.



Small Flat Brush

Best for cleaning areas with gaps, such as stove, ceramic tile grout.

Corner Brush

Ideal for cleaning mud stains, corners and narrow places, such as grout, window cracks, car tires, etc.



03 / Warm Tips

? How to have a better cleaning?

Before using spin scrubber to clean, please soak the stains with cleaning solution for 5-10 mins. Please do not soak the brush head with strong acid solution cleaner.

? Why does the brush head stop rotating when using?

Please hold the scrubber stick to aim at dirty spots without applying too much pressure on the rotating brush head, or the brush could be cut off and get damaged. The brush head will stop rotating.

? How to clean the scrubber?

Please remove the brush head and rinse it with water or clean it more thoroughly with cleaner. The remaining parts of the product (except the brush head) can be cleaned with a moistened cloth by wiping the surfaces. Do not soak the whole product (except the brush head) or shower it in water, otherwise it will be damaged!

? When the product stops working:

- It may be at low battery, please recharge it before using. Make sure all joint connections are firmly locked.
- The problem is loose connection if the product can be turned on without extension handle. You need to reconnect the handles.
- If the problem still exists, please contact our support team.

? The indicator light is not lit when charging:

- Confirm the charging interface is well connected.
- Make sure the outlet/socket is working fine.
- If the problem still exists, please contact our support team.



ELECTRIC SPIN SCRUBBER

Model: KS-2619

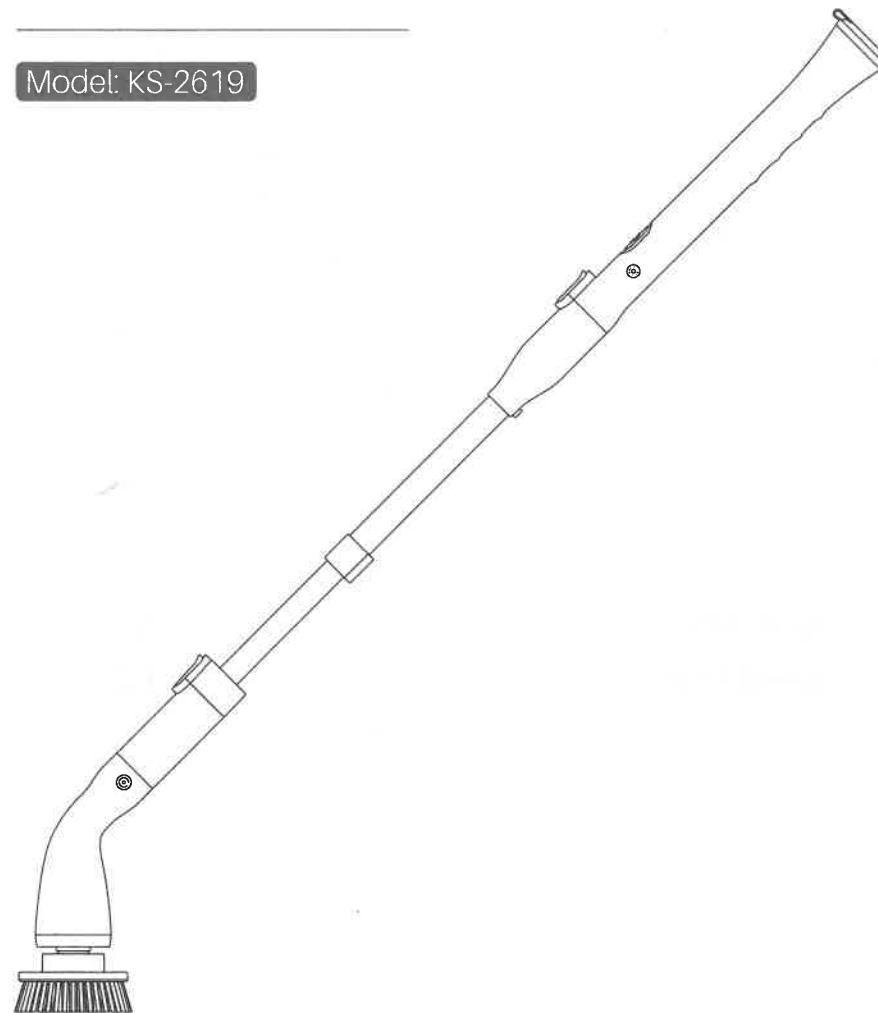

Thanks a lot for choosing our product! Please read this manual carefully before using and keep it for future reference.

PARTS INCLUDED

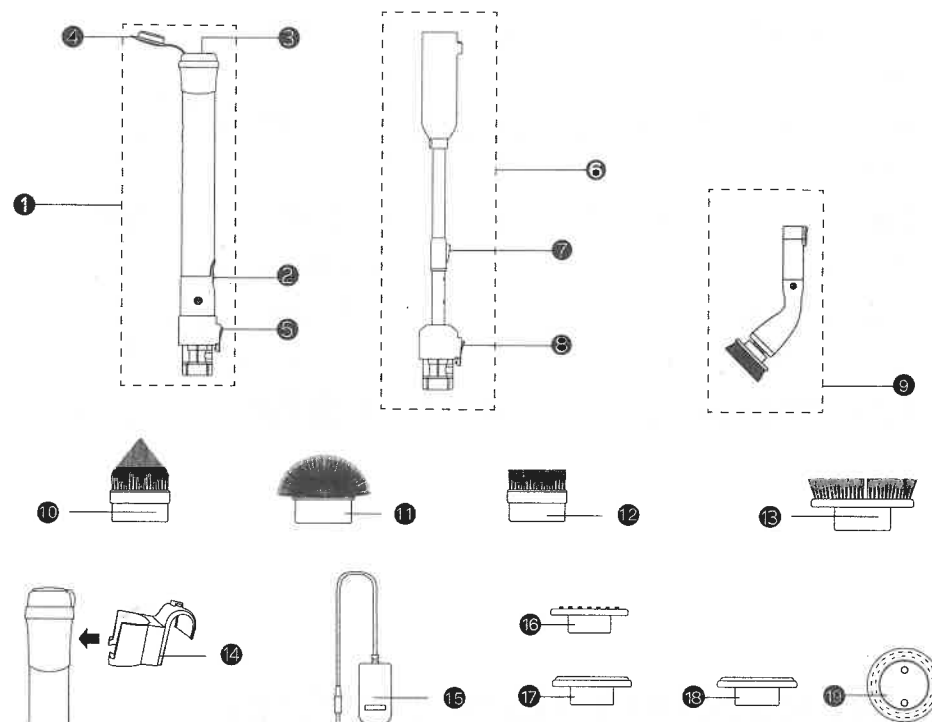

English 01
 Deutsch 15

- | | |
|--------------------------------------|----------------------|
| 1. Main Handle | 9. Scrubber Head |
| 2. Power Button | 10. Corner Brush |
| 3. Charging Port and Indicator Light | 11. Dome Brush |
| 4. Charging Cover | 12. Small Flat Brush |
| 5. Bottom Extension Release Button | 13. Large Flat Brush |
| 6. Extension Handle | 14. Hook |
| 7. Length Adjust Button | 15. Charging Adapter |
| 8. Top Extension Release Button | 16. Cleaning Cloth |
| | 17. Chenille Cloth |
| | 18. Scouring Pad |
| | 19. Velcro |

SPECIFICATIONS

Battery Type:	Li-ion Battery
Battery Capacity:	2500 mAh
Battery Quantity:	2 Batteries
Voltage:	7.4V
Input:	100-240V~, 50/60Hz
Output:	9V=== 0.65A
Charging Time:	3.5-4 Hours
Running Time:	90 Minutes
Rotating Speed:	400RPM

INSTALLATION INSTRUCTIONS

NOTE: Before assembling any component of this product, make sure that the unit is turned off.

Assembly with Extendable Handle

Assembly finished, as shown in the picture.

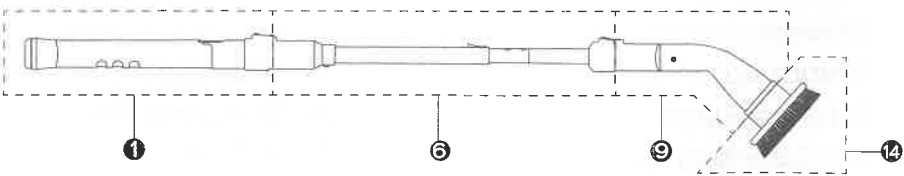

1. Connect the Main Handle to the Extendable Handle until you hear a "CLICK".

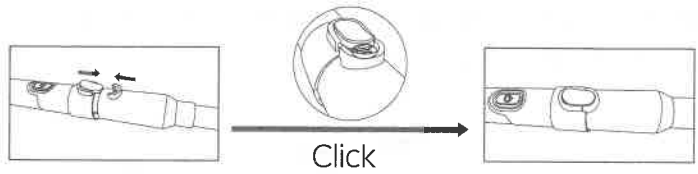

2. Next, connect the Scrubber Head to the Extendable Handle until you hear a "CLICK".

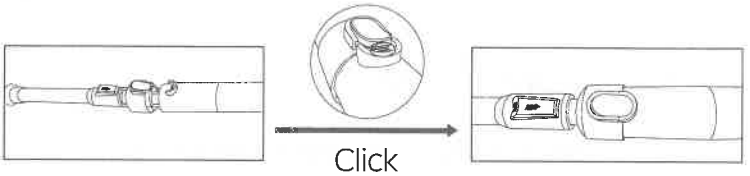

Assembly without Extendable Handle

Connect the Main Handle to the Scrubber Head until you hear a "CLICK". As the following picture shows.

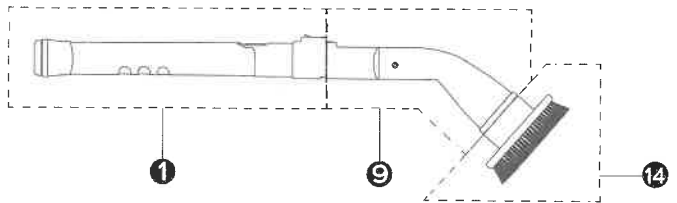

Brush Head Assembly

Firmly hold the Scrubber Head with one hand and then press the selected brush on until secured.

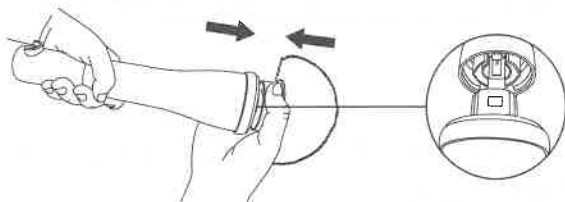

How to pull out the brush head

Hold the connection part of the brush head and pull out vertically.

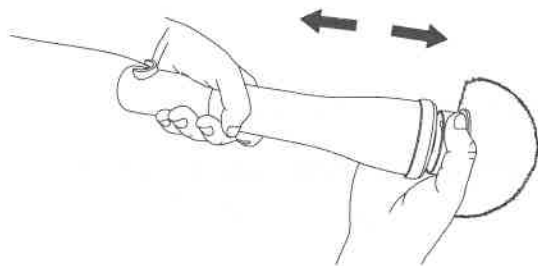

How to use the Extendable Handle

1. Turn on the adjustment button first, and then adjust the length of the extendable handle.
2. Fasten the Length Adjust Button to fix the extendable handle.

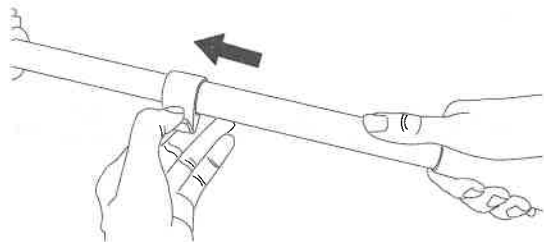

How to use the hanging hook

You could install the hook into a bar or rod to hang the power scrubber.

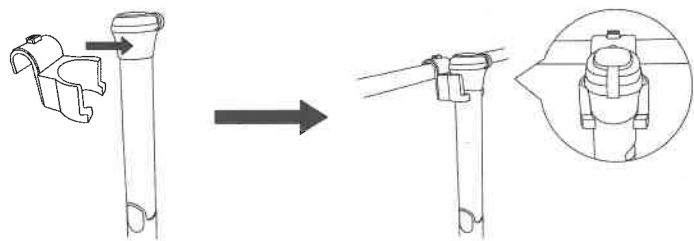

How to charge

Open silicone Charging Cover and insert adapter for charging.
Next, plug adapter into electrical outlet.

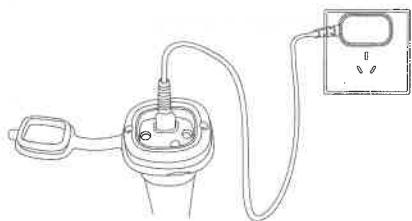

Green light	Fully charged
Red light	Charging

SUGGESTION FOR USE OF ACCESSORIES



Dome Brush: Round Brush is perfect as a concave cleaning brush for shower, tub, bathtub, sink, baseboard or toilet.



Large Flat Brush is used to clean large flat surface area, like hard floor, tile, wall, door, window, glass, counter, patio furniture, pool, soap scum, grim, stove, carpet and ceramic.

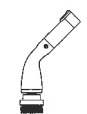

Small Flat Brush: Small flat brush head is ideal for cleaning smaller areas such as shower, kitchen, soap scum, grime, grease, stove, grill, counter and door.

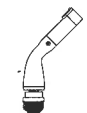

Corner Brush: Corner Brush is great for cleaning tile grout, edges, corners, cranny and tight places.



Cloth Brush: The Cloth Brush for wooden floor and furniture cleaning.

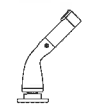

Chenille Brush: Used for cleaning household doors, windows, car doors, and other areas



Scouring pad: Stove /Kitchen Ventilator/Gas Cooker/ Suitable for cleaning baking sheets, frying pans, and other kitchen utensils.

HOW TO CLEAN THE PRODUCT

Handle Part: Gently wipe the handle part of the scrubber with a wrung soft cloth.

Brush Head: Disassemble the brush head and immerse it into the water to clean. Use a neutral detergent if it is difficult to clean.

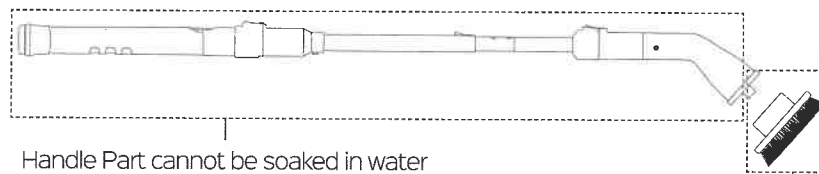

Handle Part cannot be soaked in water

Brush Head can be soaked in water

CLEANING TIPS

- For better cleaning effect, it is recommended to use the brush with detergent (such as Mold & Mildew Remover, Water Strain Remover, Oven Cleaner, Bleach Cleaner, All Purpose Cleaner). You could use different detergents for different needs.
- For removing stubborn stains, please soak stains into water and detergent for a while, and then use the scrubber to clean, it will shorten your cleaning time.

STORAGE

Storage Suggestions: Store the scrubber in a well-ventilated and shaded area. Avoid placing it in a wet place or being exposed to strong sunlight.

FAQ

1. Why the red indicator light is not on while charging?

- A. Check if the charging socket is abnormal or power outage.
- B. If the indicator light is green after plugging in the adapter, the product is fully charged, just turn it on to use.

2. The charging indicator light does not turn to green after charging over 5 hours.

- A. Please check whether the socket and charging connection are loose, plug them tightly before charging.
- B. If the red light keeps flashing and does not stop, it means that the product is in a low battery, and it needs to be fully charge before use.
- C. If neither of the above two conditions, please contact our customer service via email.

3. Why does the brush head stop spinning while working?

- A. If the red light flashes for 30s and then stops, it may be that the user presses the brush head too hard to cause the product to stop automatically in the protection state. Only switch the ON/OFF button once or twice to return to normal.
- B. If the red light keeps flashing and doesn't stop, it means that the product is in a low battery, and it needs to be fully charged before use.
- C. If not the above conditions, the product stops rotating after spinning less than 10S, or the spin does not resume after pressing the ON/OFF button twice, please contact our customer service via email.

4. Why does the charging indicator turn green

(representing a full charge) but the brush head does not spin after being turned on?

- A. Please check whether the brush head is tightly connected with the extension rod and handle. For the connection method, refer to the installation guide.
- B. If it has been well-connected and the product has not been soaked in water before, but the scrubber does not spin after turning on or it stops spinning without pressing the brush head too hard, please contact our after-sales customer service via email.

5. Why does the brush head spin is less than 90 minutes or isn't work after pressing ON/OFF button twice even when the battery is fully charged?

Each user will use different downforce during use. If you keep pressing the brush head too hard, the working time will be less than 90 mins. In order to prolong the use time, please don't press the brush head too hard, and by frequently press it too hard will break the brush head.

WARM TIPS

1. Allow for transportation safety; the product you obtained is not fully charged. Please fully charge the product before use.
2. Before using the scrubber, be careful not to get splashing stains into your eyes or on your skin.
3. When the battery is low, the red indicator light will flash, please charge the product in time.
4. When charging, the red indicator light should be on. If there is no red light, please plug the adapter correctly, and then press the power button again.
5. Please close the cover after charging to avoid water from entering as it may cause short circuit.
6. Please check whether there are any missing parts after receiving the product.

7. Please make sure that the scrubber is well assembled before use.
8. Small scratches may occur when cleaning the surface of stainless steel, polished resin, artificial marble, wood, etc., please try to confirm beforehand. Please try it out in a small area and make sure that there are no abnormalities before cleaning.
9. Please use the original adapter provided.
10. It is recommended to rest the machine after working for 30 minutes.
11. Brushes are consumable which are not applicable to the warranty.
12. Please keep the power cord plug and hands dry to avoid the risk of electric shock.
13. Do not disassemble, repair or modify internal parts by yourself, please contact us if you have any quality problems.
14. Always use proper eye protection when using the power scrubber with irritating substances. Rubber gloves are also recommended.
15. When changing accessories, please make sure to turn off the machine first.
16. Keep the hair, cloth or other parts of your body away from brush head to avoid convolving.

SAFETY INSTRUCTIONS

Caution: When using electrical appliances, basic safety precautions should always be followed, including the following:

1. This product is not a toy. Close supervision is required when any appliance is used by or near children. Store it out of reach of children.
2. If the charge cord is damaged, it must be replaced by the manufacturer or its service agent or similarly qualified person in order to avoid a hazard.
3. To protect against the risk of electric shock, do not put the battery charger in water or other liquid. Do not charge battery if it is wet or shows signs of corrosion.
4. Do not incinerate the battery. It can explode in a fire.
5. Do not attempt to use this charger with any other product.
6. Do not attempt to charge this product with any other charger.
7. Do not use the charger in wet or damp conditions.
8. For best results, do not charge a battery when it or the air temperature is below 40°F (5°C) or above 105°F(40°C).
9. Do not operate adaptor if it has received a sharp blow, been dropped, or otherwise damaged in any way. Do not disassemble the adaptor for any reason.
10. Do not abuse the cord. Do not carry the charger by the cord or yank the cord to disconnect.
11. Do not store or use the appliance close to high temperatures.

WARNING

1. The appliance is only to be used with the power supply unit provided with the appliance.(IEC/EN 60335-1)
2. WARNING: For the purposes of recharging the battery, only use the detachable supply unit provided with this appliance. (IEC 60335-1)
3. Children aged from 8 years and above and persons with reduced physical, sensory or mental capabilities or lack of experience and knowledge can use this appliance if they have been given supervision or instruction concerning use of the appliance in a safe way and understand the hazards involved. Children shall not play with the appliance. Children without supervision shall not make cleaning and user maintenance. (EN 60335- 1)
4. Persons (including children) with reduced physical, sensory or mental capabilities or lack of experience and knowledge do not intend this appliance for use, unless a person responsible for their safety has given them supervision or instruction concerning use of the appliance. Children should be supervised to ensure that they do not play with the appliance. (IEC 60335- 1)

FCC STATEMENT

Operation is subject to the following two conditions:

- (1) This device may not cause harmful interference, and
- (2) this device must accept any interference received, including interference that may cause undesired operation.

Note: This equipment has been tested and found to comply with the limits for a Class B digital device, pursuant to part 15 of the FCC Rules. These limits are designed to provide reasonable protection against harmful interference in a residential installation. This equipment generates, uses and can radiate radio frequency energy and, if not installed and used in accordance with the instructions, may cause harmful interference to radio communications. However, there is no guarantee that interference will not occur in a particular installation. If this equipment does cause harmful interference to radio or television reception, which can be determined by turning the equipment off and on, the user is encouraged to try to correct the interference by one or more of the following measures:

- Reorient or relocate the receiving antenna.
- Increase the separation between the equipment and receiver.
- Connect the equipment into an outlet on a circuit different from that to which the receiver is connected.
- Consult the dealer or an experienced radio/TV technician for help.