

HAND MIXER



Model Number:

169204

UPC: 681131692045

Customer Assistance

1 877 207 0923 (US)

1 877 556 0973 (Canada)



Thank you for purchasing this GE appliance.

In keeping with the GE ecomagination initiative, please consider the option to recycle the packaging material and donate any appliance you are no longer using.

To read more about GE's ecomagination commitment, visit:

ge.ecomagination.com

IMPORTANT SAFEGUARDS

When using electrical appliances, basic safety precautions should always be followed, including the following:

- **Read all instructions.**
- To protect against risk of electrical shock, do not immerse body mixer or cord in the water or other liquid. If body mixer or cord falls into liquid, unplug the cord from outlet immediately. Do not reach into the liquid.
- Close supervision is necessary when mixer is used by or near children.
- Unplug from outlet when not in use, before putting on or taking off parts and before cleaning.
- Avoid contacting moving parts. Keep hands, hair, clothing, as well as spatulas and other utensils away from beaters or dough hooks during operation to reduce risk of injury to persons, and/or damage to the mixer.
- Keep hands and utensils out of container to reduce the risk of injury to persons or damage the mixer.
- Do not operate appliance with a damaged cord or plug, or after the appliance malfunctions or is dropped or damaged in any manner. Call our toll-free customer assistance number for information on examination, repair, or adjustment.
- The use of accessories or services not recommended or provided by the manufacturer may cause fire, electrical shock or injury.
- Do not use outdoors or in a damp area.
- Do not let the cord hang over edge of table or counter or touch hot surfaces.
- Remove the beaters or dough hooks from mixer before washing.
- Do not place mixer on or near a hot burner (gas or electric).
- Do not use appliance for other than intended use.
- Do not continuously use the mixer longer than 5 minutes at one time.
- Do not fill the mixing container more than 90% of its capacity.
- Do not mix hot ingredients.
- Never add to container while appliance operating.
- The whisk should be used without any other attachment.

SAVE THESE INSTRUCTIONS!

ADDITIONAL SAFEGUARDS

This appliance is for **HOUSEHOLD USE ONLY**.

DO NOT OPERATE APPLIANCE IF THE LINE CORD SHOWS ANY DAMAGE OR IF APPLIANCE WORKS INTERMITTENTLY OR STOPS WORKING ENTIRELY.

EXTENSION CORDS

A short power-supply cord is to be provided to reduce the risk resulting from becoming entangled in or tripping over a longer cord. Longer detachable power-supply cords or extension cords are available and may be used if care is exercised in their use. If a longer detachable power-supply cord or extension cord is used,

- 1) The marked electrical rating of the cord set or extension cord should be at least as great as the electrical rating of the appliance, and
- 2) The longer cord should be arranged so that it will not drape over the countertop or tabletop where it can be tripped over, snagged, or pulled on unintentionally (especially by children).

POLARIZED PLUG

This appliance has a polarized plug (one blade is wider than the other). To reduce the risk of electric shock, this plug is intended to fit into a polarized outlet only one way. If the plug does not fit fully into the outlet, reverse the plug. If it still does not fit, contact a qualified electrician. Do not attempt to modify the plug in any way.

PARTS



- 1 **eject** button
- 2 **slow start** button
- 3 LED display
- 4 **⏻ on/off** button
- 5 **⊕** button
- 6 **⊖** button
- 7 Power cord with plug
- 8 Heel stand
- 9 Openings for attachments

- 10 Hand mixer plug

Accessories:

- 11 Beater attachments
- 12 Dough attachments
- 13 Whisk attachment
- 14 Collar disc
- 15 Storage case (shown with mixer)

ILLUSTRATIONS

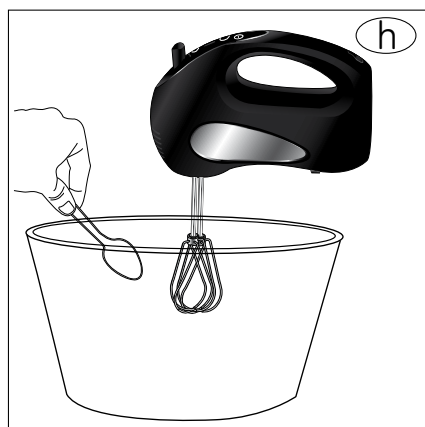
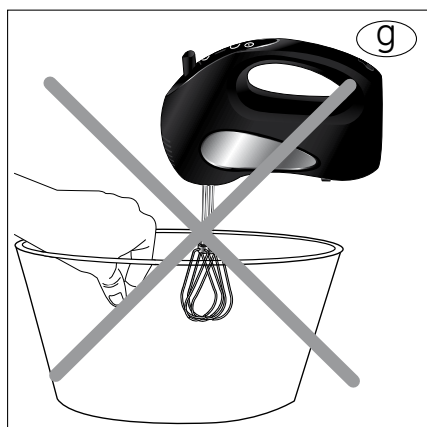
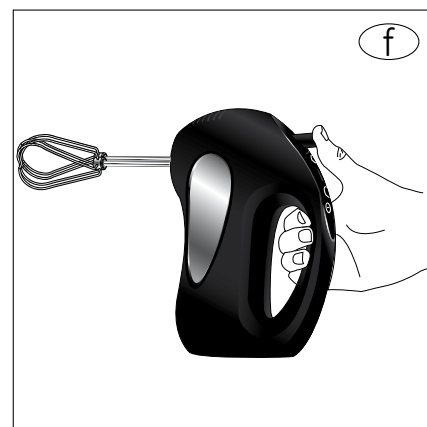
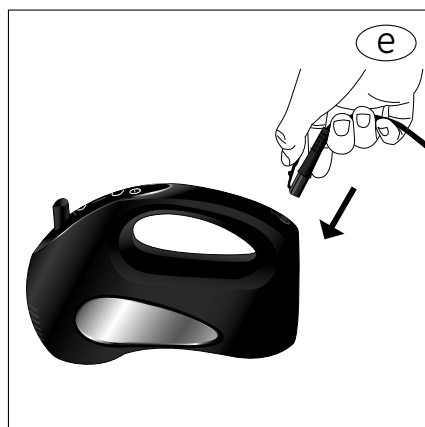
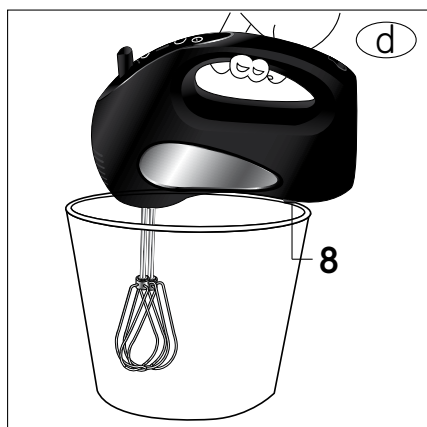
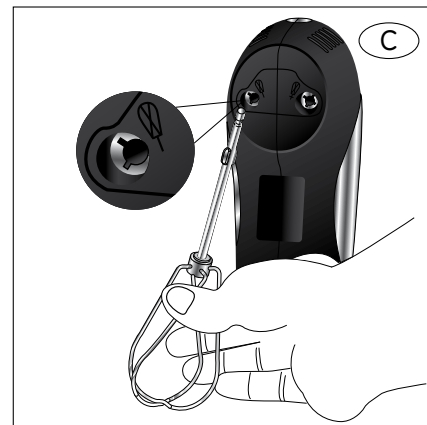
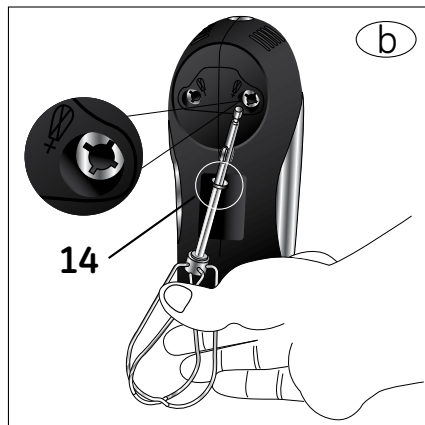
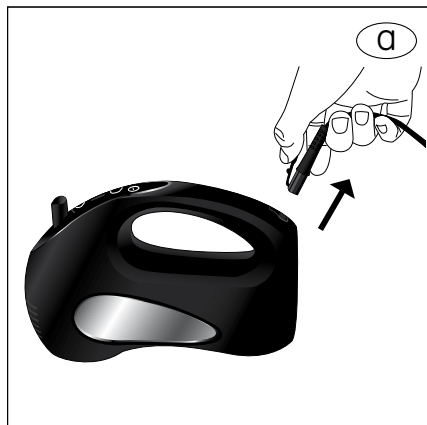

OPERATION

Before first use

- Remove all packaging materials, labels and/or stickers from your hand mixer.
- Clean your hand mixer thoroughly before using for the first time (↳ Cleaning). The hand mixer must not be connected to power during cleaning (ill. (a)).

Warning: Do not immerse the hand mixer in water or any liquids. This may cause electric shock or damage the appliance.

Operating instructions

Before plugging in the hand mixer, check that the electrical circuit is not overloaded with other appliances.

- Insert the desired attachment (**11 to 13**) with the collar disc (**14**) into the bigger right opening. Push until it sits safely in place (ill. (b)).

Warning: Attachments should be used as a set (2 dough hooks or 2 beaters or 1 whisk). Do not mix attachments.

- Insert the other attachment (**11 to 12**) into the smaller left opening. Push until it sits safely in place (ill. (c)).
- Fill ingredients you want to mix into a bowl. The heel stand (**8**) lends support so that the hand mixer will not slide off the bowl while the mixer is switched off (ill. (d)).

Note: The mixer can also rest on the heel stand (**8**) during periods of non-use, for example, when you are adding ingredients to the mixture. However, never place the mixer on the heel stand (**8**) while the appliance is switched on. Also, make sure that the bowl on which edge the mixer is resting on will not fall over.

- Connect the hand mixer plug (**10**) to its socket (ill. (e)). Connect the power plug (**7**) with a wall outlet.
- Press **slow start** button (**2**) (↳ Slow start) and the LED display (**3**) lights up.
- Press **on/off** button (**4**) to switch the hand mixer on.
- Thoroughly mix the ingredients.
- Press **on/off** button (**4**) again to switch the hand mixer off.

Slow start

The slow start function is on by default. When the mixer is turned on with the slow start function active, the inserted accessories (**11 to 13**) start spinning very slowly to prevent ingredients from splattering.

OPERATION

- To switch off slow start press **slow start** button **(2)**. Deactivating slow start comes in handy when thick doughs that will not splatter are being mixed.

Speed setting

- There are 6 speed settings available. The speed can be adjusted anytime by pressing the \oplus/\ominus buttons **(5, 6)**:
Press \oplus button **(5)**: increase speed
Press \ominus button **(6)**: decrease speed
- The selected speed setting is shown in the display **(3)**.

	Speed setting	Use
Low	1	<ul style="list-style-type: none"> Slow mixing for combining and aerating dry ingredients without splattering Add ingredients to cookie doughs or cake batters Fold creams or egg whites into batters Start mixing frostings Stir sauces and gravies Mix muffin or pancake batters
	2	<ul style="list-style-type: none"> Cream cold butter and sugar Mash potatoes or squash Add dry ingredients to doughs or batters
Medium	3	<ul style="list-style-type: none"> Start mixing cake mixes Add eggs to doughs or batters Add dry ingredients with liquid ingredients Cream softened butter and sugar Whip potatoes or squash
	4	<ul style="list-style-type: none"> Whip cream (with the whisk attachment (13)) Finish beating butter cream frostings Finish beating cake mixes
	5	<ul style="list-style-type: none"> Beat whole eggs or yolks Mix thin batters
High	6	<ul style="list-style-type: none"> Add sugar to whipped egg whites for meringues Beat egg yolks until thick and light Whip egg whites

OPERATION

Speed setting cycles

- The speed adjustment can be set in cycles, when the appliance is in stand-by mode.

Press repeatedly	Cycle
⊕ (6)	1, 2, 3, 4, 5, (6), 5, 4, 3, 2, 1
⊖ (1)	6, 5, 4, 3, 2, (1), 2, 3, 4, 5, 6

- If the appliance is operated, the speed setting can only be set from 1-6 or 6-1 without cycling. This way strong vibrations are avoided.

Press repeatedly	Cycle
⊕ (1)	1, 2, 3, 4, 5, 6
⊖ (6)	6, 5, 4, 3, 2, 1

Removing attachments

- Press **on/off** button (4) to turn off the hand mixer. Remove the attachments (11 to 13) from the bowl.
- Disconnect the power plug (7) from the wall outlet.
- Hold the attachments (11 to 13) at their stems.
- Press the **eject** button (1) to release the attachments (11 to 13) from the hand mixer (ill. .

OPERATION

- The whisk attachment **(13)** can be attached at either opening. Press **eject** button **(1)** to release it after use.

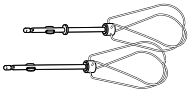
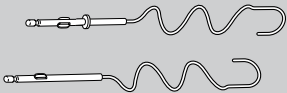
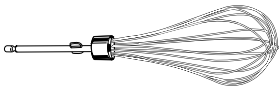
Attachment		Use
Beaters (11)		<ul style="list-style-type: none">Whipping cream
Dough hooks (12)		<ul style="list-style-type: none">Mixing heavy batters like bread or pizza batters
Whisk (13)		<ul style="list-style-type: none">Mixing thick batters

Hint: Operate the hand mixer for a short time only. Press the **on/off** button **(4)** once the perfect consistency is reached.

Warning: Always turn the hand mixer off and unplug when not in use.

CLEANING

Clean the hand mixer after every use. This appliance contains no user serviceable parts and requires little maintenance. Leave any servicing or repairs to qualified personnel.

- Clean the outside of the hand mixer with a damp soft cloth.
- Clean the attachments **(11 to 13)** thoroughly after each use. The attachments are suitable for use in a dishwasher.
- Do not use abrasive cleansers.

WARNING: Never immerse the hand mixer in water or other liquids (*ill.* ⓘ).

Storage

Clean and dry all parts before storing. Store the hand mixer in its storage case **(15)** or in a clean, dry place. Never wrap the cord **(7)** around the hand mixer.

TROUBLESHOOTING

Problem	Possible Cause	Solution
The motor works very slowly.	♦ Too many ingredients in the bowl.	♦ Remove some foods and restart.
The motor does not work.	♦ Too many foods in the bowl. ♦ The hand mixer is in stand-by mode. ♦ The motor is damaged.	♦ Remove some foods and restart. ♦ Press the  on/off button (4) to start.

If additional assistance is needed, please contact our Customer Assistance at 1.877.207.0923 (U.S.) or 1.877.556.0973 (Canada).

TECHNICAL DATA

Rated voltage:	120V ~60Hz
Rated current:	2.5A
Rated power input:	300W
Dimensions:	259mm (L) x 244mm (W) x 109mm (H)
Weight (without package):	1.3kg

CUSTOMER ASSISTANCE

If you have a claim under this warranty, please call our Customer Assistance Number. For faster service, please have the model number and product name ready for the operator to assist you. This number can be found on the bottom of your appliance and on the front page of this manual.

Model Number: _____ **Product Name:** _____

Customer Assistance Number 1.877.207.0923 (U.S.) or 1.877.556.0973 (Canada).

Keep these numbers for future reference!

For more information, please visit us at WWW.GEHOUSEWARES.COM

Two-year limited warranty

What does your warranty cover?

- Any defect in material or workmanship.

For how long after the original purchase?

- Two years.

What will we do?

- Provide you with a new one.
- For those items still under warranty but no longer available, WAL-MART reserves the right to replace with a similar GE branded product of equal or greater value.

How do you make a warranty claim?

- Save your receipt.
- Properly pack your unit. We recommend using the original carton and packing materials.
- Return the product to your nearest WAL-MART store or call Customer Assistance at 1-877-207-0923 (U.S.) or 1-877-556-0973 (Canada).

What does your warranty not cover?

- Parts subject to wear, including, without limitation, glass parts, glass containers, cutter/strainer, blades, seals, gaskets, clutches, motor brushes, and/or agitators, etc.
- Commercial use or any other use not found in printed directions.
- Damage from misuse, abuse, or neglect, including failure to clean product regularly in accordance with manufacturer's instructions.

How does state law relate to this warranty?

- This warranty gives you specific legal rights, and you may also have other rights which vary from state to state or province to province.
- This warranty is in lieu of any other warranty or condition, whether express or implied, written or oral, including, without limitation, any statutory warranty or condition of merchantability or fitness for a particular purpose.
- WAL-MART, GE and the product manufacturer expressly disclaim all responsibility for special, incidental, and consequential damages or losses caused by use of this appliance. Any liability is expressly limited to an amount equal to the purchase price paid whether a claim, however instituted, is based on contract, indemnity, warranty, tort (including negligence), strict liability, or otherwise. Some states or provinces do not allow this exclusion or limitation of incidental or consequential losses, so the foregoing disclaimer may not apply to you.

What if you encounter a problem with this product while using it outside the country of purchase?

- The warranty is valid only in the country of purchase and if you follow the warranty claim procedure as noted.



is a trademark of General Electric Company and is used under the license by Wal-Mart Stores Inc., Bentonville, AR 72716

Marketed in Canada by:

Wal-Mart Canada Corp.
1940 Argentia Road, Mississauga,
Ontario L5N1P9