

NOTE

This equipment has been tested and found to comply with the limits for a Class B digital device, pursuant to Part 15 of the FCC Rules. These limits are designed to provide reasonable protection against harmful interference in a residential installation. This equipment generates, uses and can radiate radio frequency energy and, if not installed and used in accordance with the instructions, may cause harmful interference to radio communications. However, there is no guarantee that interference will not occur in a particular installation. If this equipment does cause harmful interference to radio or television reception, which can be determined by turning the equipment off and on, the user is encouraged to try to correct the interference by one or more of the following measures:

- Reorient or relocate the receiving antenna.
- Increase the separation between the equipment and receiver.
- Connect the equipment into an outlet on a circuit different from that to which the receiver is connected.
- Consult the dealer or an experienced radio/TV technician for help.

CAUTION: Changes or modifications not expressly approved by the party responsible for compliance could void the user's authority to operate the equipment.

Supplier's Declaration of Conformity

47 CFR § 2.1077 Compliance Information

Trade Name: LeapFrog®
 Model: 6132
 Product Name: LeapLand Adventures™
 Responsible Party: LeapFrog Enterprises, Inc.
 Address: 2200 Powell Street, Suite 500,
 Emeryville, California 94608
 Website: leapfrog.com

THIS DEVICE COMPLIES WITH PART 15 OF THE FCC RULES. OPERATION IS SUBJECT TO THE FOLLOWING TWO CONDITIONS: (1) THIS DEVICE MAY NOT CAUSE HARMFUL INTERFERENCE, AND (2) THIS DEVICE MUST ACCEPT ANY INTERFERENCE RECEIVED, INCLUDING INTERFERENCE THAT MAY CAUSE UNDESIRE OPERATION.

This device contains licence-exempt transmitter(s)/receiver(s) that comply with Innovation, Science and Economic Development Canada's licence-exempt RSS(s). Operation is subject to the following two conditions:

- (1) This device may not cause interference.
- (2) This device must accept any interference, including interference that may cause undesired operation of the device.

L'émetteur/récepteur exempt de licence contenu dans le présent appareil est conforme aux CNR d'Innovation, Sciences et Développement économique Canada applicables aux appareils radio exempts de licence. L'exploitation est autorisée aux deux conditions suivantes :

- 1) L'appareil ne doit pas produire de brouillage.
- 2) L'appareil doit accepter tout brouillage radioélectrique subi, même si le brouillage est susceptible d'en compromettre le fonctionnement.

CAN ICES-003(B)/NMB-003(B)



HIGH-DEFINITION MULTIMEDIA INTERFACE

The terms HDMI, HDMI High-Definition Multimedia Interface, and the HDMI Logo are trademarks or registered trademarks of HDMI Licensing Administrator, Inc.



Quick Start Guide



We aim to reduce our environmental impact and have reduced the amount of paper used for our printed manuals. The full version of the manual is available online through the following link or by scanning the QR code.

For US



leapfrog.com/guides

For Canada



leapfrog.com/en-ca/support/products

For AUS



leapfrog.com/en-au/support/products/all-products

Read our complete warranty policy online at leapfrog.com/legal

INCLUDED IN THIS PACKAGE

- 1 wireless controller
- 1 HDMI game stick
- 1 micro USB power cable
- Quick Start Guide

WARNING

All packing materials such as tape, plastic sheets, packaging locks, removable tags, cable ties and packaging screws are not part of this toy and should be discarded for your child's safety.

NOTE

Please keep this Quick Start Guide as it contains important information.

ATTENTION

Pour la sécurité de votre enfant, débarrassez-vous de tous les produits d'emballage tels que rubans adhésifs, feuilles de plastique, attaches, étiquettes et vis d'emballage. Ils ne font pas partie du jouet.

NOTE

Il est conseillé de conserver ce guide des parents car il comporte des informations importantes.

GETTING STARTED

INITIAL SETUP

1. Plug the USB B Connector end of the **Micro USB Power Cable** into the USB B port on the **HDMI Game Stick**.
2. Plug the **HDMI Game Stick** into an HDMI port on your television.
3. Plug the USB A Connector end of the **Micro USB Power Cable** into a USB port on your television or other qualified DC 5V adapter with output no less than 500mA.

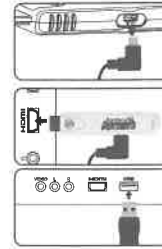

2

BATTERY REMOVAL AND INSTALLATION

1. Find the battery cover located on the back of the **Wireless Controller**, use a coin or screwdriver to loosen the screw and then open the battery cover.
2. Remove old batteries by pulling up on one end of each battery.
3. Install 2 new AA (AM-3/LR6) batteries following the diagram inside the battery box.
4. Replace the battery cover and tighten the screw to secure.

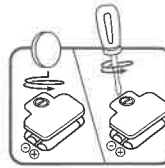

WARNING:

Adult assembly required for battery installation. Keep batteries out of reach of children.



ATTENTION :

Les piles ou accumulateurs doivent être installés par un adulte. Tenir les piles ou accumulateurs hors de portée des enfants.

IMPORTANT: BATTERY INFORMATION

- Insert batteries with the correct polarity (+ and -).
- Do not mix old and new batteries.
- Do not mix alkaline, standard (carbon-zinc) or rechargeable batteries.
- Only batteries of the same or equivalent type as recommended are to be used.
- Do not short-circuit the supply terminals.
- Remove batteries during long periods of non-use.
- Remove exhausted batteries from the toy.
- Dispose of batteries safely. Do not dispose of batteries in fire.
- Disposing batteries into a fire or a hot oven or mechanically crushing or cutting a battery can result in an explosion.
- Leaving batteries in extremely high temperatures may result in an explosion or can cause leakage of flammable liquids or gas.
- A battery subjected to extremely low air pressure may result in an explosion or the leakage of flammable liquid or gas.

3

RECHARGEABLE BATTERIES

- Remove rechargeable batteries from the toy before charging.
- Rechargeable batteries are only to be charged under adult supervision.
- Do not charge non-rechargeable batteries.

NOTE

If the **Wireless Controller** powers down or if the light fades out during play, please install a new set of batteries.

CARE & MAINTENANCE

1. Keep the unit clean by wiping it with a slightly damp cloth.
2. Keep the unit out of direct sunlight and away from any direct heat sources.
3. Remove the batteries if the unit will not be in use for an extended period of time.
4. Do not drop the unit on hard surfaces and do not expose the unit to moisture or water.
5. Always keep the **Wireless Controller** and **HDMI Game Stick** away from water.
6. Examine the **Micro USB Power Cable** regularly, checking for damage to the cable, plugs and other parts. Do not use the **Micro USB Power Cable** if there is any damage.

TROUBLESHOOTING

If you are unable to insert the **HDMI Game Stick** directly into the HDMI port on your television due to clearance issues, a third-party HDMI extension cable may be a good solution. A short HDMI extension cable can be purchased from major electronics retailers.



If for some reason the unit stops working or malfunctions, please follow these steps:

HDMI Game Stick

1. Interrupt the power supply by unplugging the USB A Connector end of the **Micro USB Power Cable** from the USB port on your television or other qualified DC 5V adapter with output no less than 500mA.

4

2. Unplug the **HDMI Game Stick** from the HDMI port on your television.
3. Wait for 10 Seconds, then plug the **HDMI Game Stick** into the HDMI port on your television.
4. Plug the USB A Connector end of the **Micro USB Power Cable** into the USB port on your television or other qualified DC 5V adapter with output no less than 500mA. The unit will now be ready to play again.

Wireless Controller

1. Interrupt the power supply by removing the batteries.
2. Let the unit stand for 10 seconds, then replace the batteries.
3. The unit will now be ready to play again.
4. If the unit still does not work, replace with an entire set of new batteries.

OTHER NOTES

Static electricity may cause the **HDMI Game Stick** to malfunction. In cases where the **HDMI Game Stick** is malfunctioning due to static electricity, disconnect the **Micro USB Power Cable**, wait for 10 seconds, then reconnect the **Micro USB Power Cable** to reboot the **HDMI Game Stick**.

FCC Compliance Statement

After completing the steps in the **Initial Setup** section, power on the television. FCC e-labeling will be shown on the television for the U.S. version of **LeapLand Adventures™**.

This screen confirms that this product complies with FCC regulations.

IMPORTANT NOTE:

If the problem persists, please call our **Consumer Services Department** at **1-800-701-5327** in the U.S. and Canada, or email **support@leapfrog.com**. Creating and developing LeapFrog products is accompanied by a responsibility that we take very seriously. We make every effort to ensure the accuracy of the information, which forms the value of our products. However, errors sometimes can occur. It is important for you to know that we stand behind our products and encourage you to contact us with any problems and/or suggestions you might have. A service representative will be happy to help you.

5